

INVERTED MESA BLANK SPECIFICATION

(ROUND TYPE)

1 Cut	<u>AT</u>			
2 Orientation				
ZZ' Angle(Θ)	<u>35</u> Deg.	<u>18</u> min.	<u>0</u> sec. \pm	<u>30</u> sec.
XX' Angle(Φ)	<u>0</u> Deg.	<u>0</u> min.	<u>0</u> sec. \pm	<u>15</u> min.
	@ EFG Angle			
3 Dimension				
Diameter	<u>5.000</u> mm +	<u>0.000</u> mm -	<u>0.050</u> mm	
Flatness	<u>0.200</u> mm +	<u>0.000</u> mm -	<u>0.030</u> mm	
Ref. Flat. On	<u>+X</u> Axis	parallel to the ZZ' axis within $\pm 10\%$		
Mesa Diameter	<u>3.200</u> mm +	<u>0.000</u> mm -	<u>0.030</u> mm	
Mesa Ring	<u>0.900</u> mm +	<u>0.000</u> mm -	<u>0.030</u> mm	

Plasma Etching Method

Single Side Etching

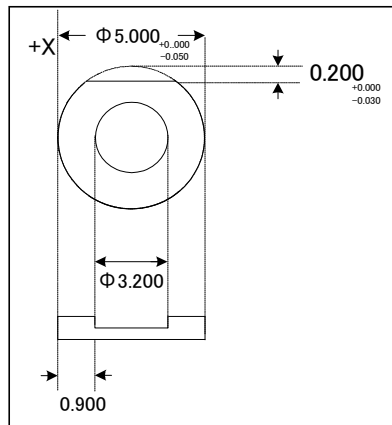

4 Frequency			
Mesa Frequency	<u>70.700</u> MHz \pm	<u>90</u> KHz	
Overtone	<u>Fundamental</u>		
Sorting	<u>20</u> KHz / group		
Mesa Ring Frequency	<u>35.000</u> MHz \pm	<u>1</u> MHz	

5 Surface finish Optical Polish

6 Material Normal

7 Etch Channel None (in Mesa Area)
150 pcs./cm² max. (in Mesa Ring)

8 Q Value Minimum 2 million

9 REMARK No fault such as etch channel , scratch, crack chipping in Mesa area

AATA JAPAN CO.,LTD.

INTL TEL No.81-45-662-0533
 INTL FAX No.81-45-681-4349
 URL: <http://www.aatajapan.co.jp>
 E-mail: aata-jap@pluto.dti.ne.jp