

INVERTED MESA BLANK SPECIFICATION
(UNPLATED RECTANGULAR (STRIP) TYPE)

1 Cut	<u>AT</u>			
2 Orientation				
ZZ' Angle(Θ)	<u>35</u> Deg.	<u>18</u> min.	<u>0</u> sec. \pm	<u>30</u> sec.
XX' Angle(Φ)	<u>0</u> Deg.	<u>0</u> min.	<u>0</u> sec. \pm	<u>15</u> min.
	@ EFG Angle			
3 Dimension				
Width A (ZZ')	<u>5.000</u> mm +	<u>0.000</u> mm -	<u>0.010</u> mm	
Length B (XX')	<u>3.000</u> mm +	<u>0.000</u> mm -	<u>0.010</u> mm	
Mesa Width C	<u>3.800</u> mm +	<u>0.000</u> mm -	<u>0.010</u> mm	
Mesa Length D	<u>2.400</u> mm +	<u>0.000</u> mm -	<u>0.010</u> mm	

Plasma Etching Method
 Single Side Etching

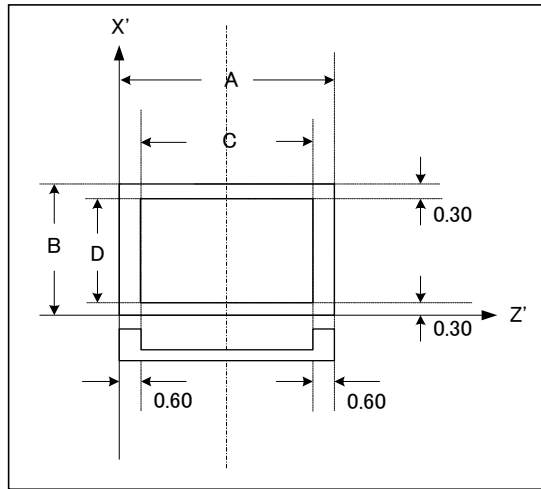

4 Frequency	
Mesa Frequency	<u>100.000</u> MHz \pm <u>150</u> KHz
Overtone	<u>Fundamental</u>
Sorting	<u>50</u> KHz / group
Mesa Ring Frequency	<u>35.000</u> MHz \pm <u>1</u> MHz

5 Surface finish Optical Polish

6 Material Normal

7 Etch Channel None (in Mesa Area)
150 pcs./cm² max. (in Mesa Ring)

8 Q Value Minimum 2 million

9 REMARK No fault such as etch channel , scratch, crack chipping in Mesa area

AATA JAPAN CO.,LTD.

INT'L TEL No.81-45-662-0533
 INT'L FAX No.81-45-681-4349
 URL: <http://www.aatajapan.co.jp>
 E-mail:aata-jap@pluto.dti.ne.jp